



YETDA INDUSTRY LTD.

0.28" DUAL DIGIT RED LED DISPLAY

D-2824AUF11-KW

DESCRIPTION

- * 0.28" (7.00mm) Inch Digit Height.
- * Super Bright Red Display.
- * Black Face and White Segment Color.
- * Common Anode.

ABSOLUT MAXIMUM RATINGS AT Ta=25°C

Parameter		UNIT
Power Dissipation Per Seg.	40	mW
Peak Forward Current Per Seg.	80	mA
Forward current Per Seg.	20	mA
Reverse Voltage Per Seg.	5	V
Operation Temperature Range	-40°C TO +85°C	°C
Storage Temperature Range	-40°C TO +85°C	°C
Lead Soldering Temperature	260°C for 3 seconds 1.6mm(1/16 inch) from body	

ELECTRICAL/OPTICAL CHARACTERISTIC AT Ta=25°C

PARAMETER	SYMBOL	MIN.	TYP.	MAX.	UNIT	CONDITION
Average Luminous Intensity	I _v	25	30	33	mcd	I _F =20mA
Emission Wavelength	λ _D		638	645	nm	I _F =20mA
Forward Voltage Per Seg.	V _F		2.0	2.3	V	I _F =20mA
Reverse Current Per Seg.	I _R			10	uA	V _R =5V
Luminous Intensity Matching Ratio	I _v -m			2 : 1		I _F =20mA



YETDA INDUSTRY LTD.

P.C.B. Pin Connection

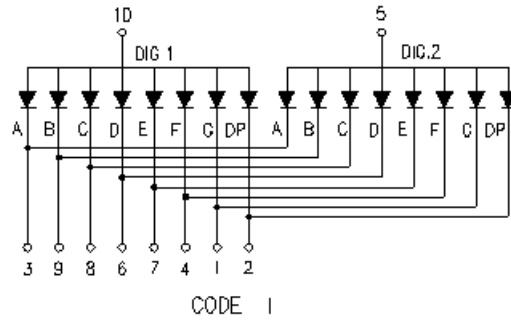

Reflector Dimensions

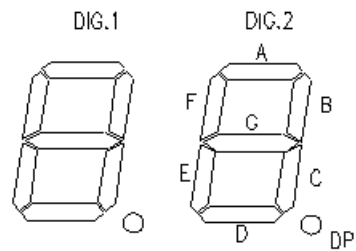
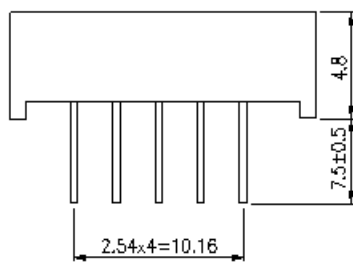
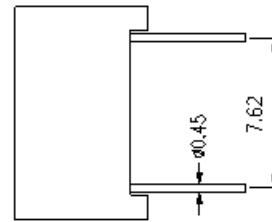
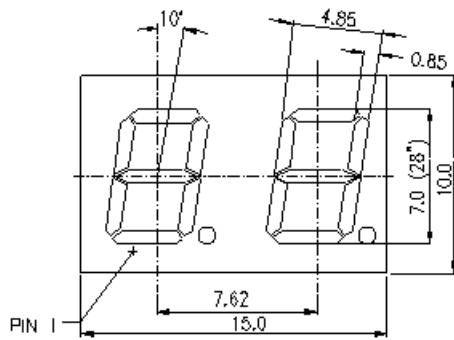

Unit:mm



YETDA INDUSTRY LTD.

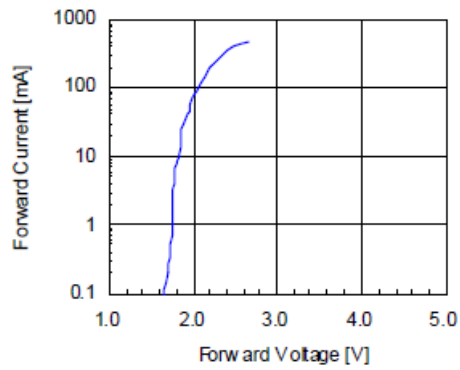

Fig 3. Forward Voltage vs. Temperature

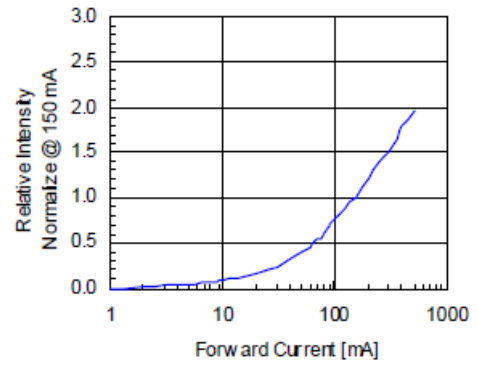

Fig 4. Relative Intensity vs. Temperature

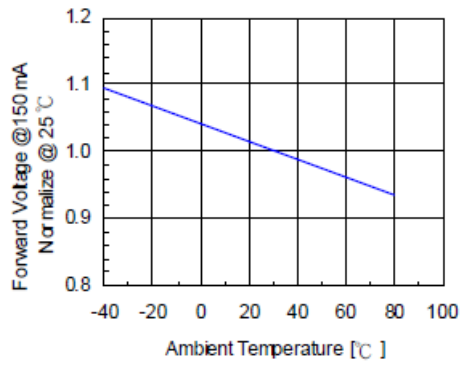
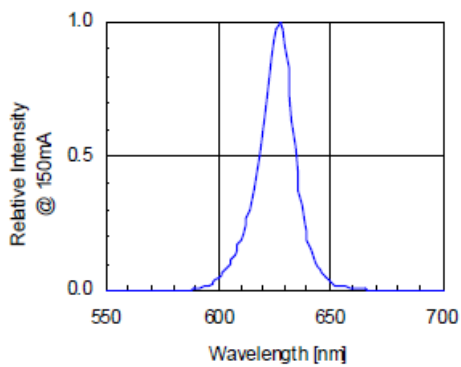
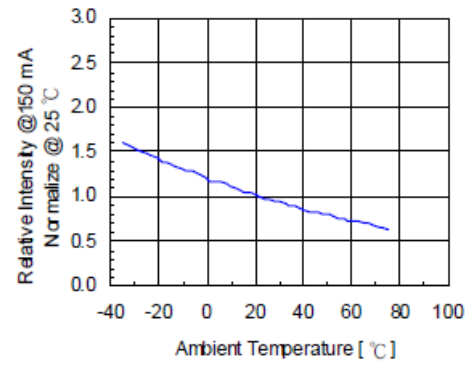

Fig 5. Relative Intensity vs. Wavelength





YETDA INDUSTRY LTD.

Soldering

Manual of soldering

The temperature of the iron tip should not be higher than 260 °C and

Soldering within 3 seconds per solder-land is to be observed

1. DIP soldering (Wave Soldering):

Preheating: 120

°C ~ 150°C within 5 sec. 260°C (Max)

Gradual Cooling (Avoid quenching)

