



YETDA INDUSTRY LTD.

## 8mm Super Bright Bluish Green LED Lamps S800TE4D

8 mm with InGaN Dice ◦

Encapsulated with Water Clear Lens Package ◦

Long Leads ◦

### Absolute Maximum Ratings : ( Ta=25°C )

| Parameter                   | Maximum Rating                                     | Unit |
|-----------------------------|--|------|
| Peak Forward Current        | 120  | mA   |
| Continuous Forward Current  | 30   | mA   |
| Operating Temperature Range | -40°C to +85°C                                     |      |
| Storage Temperature Range   | -50°C to +100°C                                    |      |
| Lead Soldering Temperature  | 260°C for 3 seconds<br>1.6mm(0.063 inch) from body |      |

### Electro-Optical Characteristics ( Ta = 25°C )

| Parameter Radiant  | Test Condition        | Symbol             | Min. | Typ. | Max.  | Unit |
|--------------------|-----------------------|--------------------|------|------|-------|------|
| Forward Voltage    | I <sub>F</sub> = 20mA | V <sub>F</sub>     | 2.8  | 3.0  | 3.4   | V    |
| Reverse Current    | V <sub>R</sub> = 5V   | I <sub>R</sub>     |      |      | 10    | uA   |
| Luminous Intensity | I <sub>F</sub> = 20mA | I <sub>v</sub>     | 8000 |      | 10000 | mcld |
| Spectral Bandwidth | I <sub>F</sub> = 20mA | Δλ                 | 30   | 32   | 35    | nm   |
| Wavelength         | I <sub>F</sub> = 20mA | λ <sub>p</sub>     |      |      |       | nm   |
|                    |                       | λ <sub>d</sub>     |      | 505  |       | nm   |
| Viewing Angle      | I <sub>F</sub> = 20mA | 2 θ <sub>1/2</sub> |      | 80   |       | deg  |

Package

Item: (8mm) 800

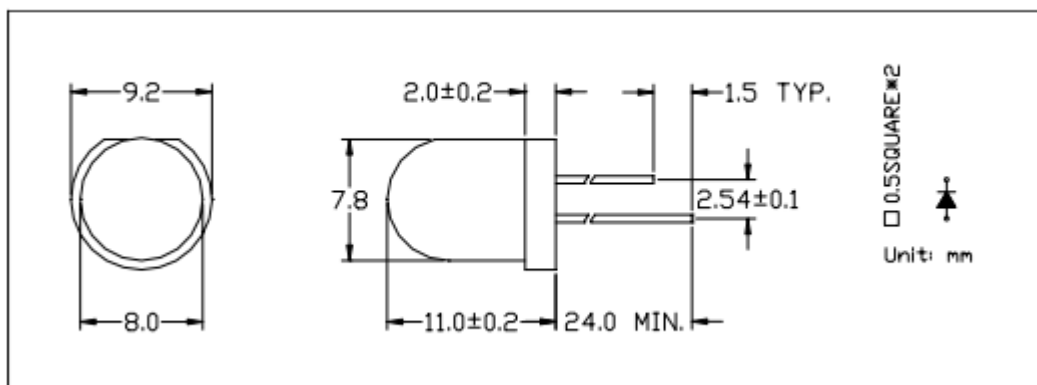



# YETDA INDUSTRY LTD.

## •Soldering:

### 1. Manual of soldering

The temperature of the iron tip should not be higher than 260 °C and

Soldering within 3 seconds per solder-land is to be observed

### 2. DIP soldering (Wave Soldering):

Preheating: 120

°C ~ 150°C within 5 sec. 260°C (Max)

Gradual Cooling (Avoid quenching)

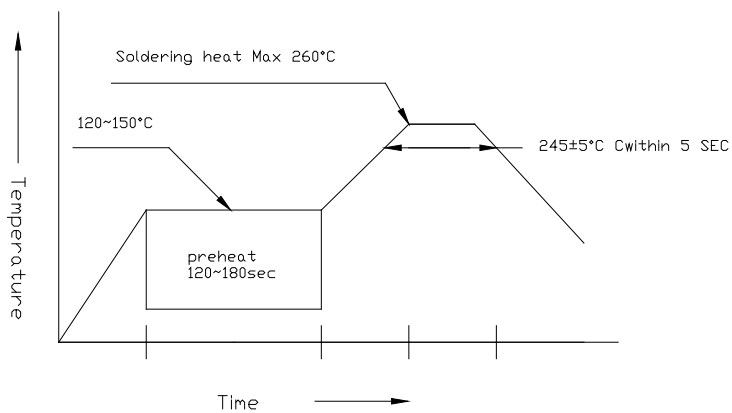

### 3. Reflow Soldering

Preheating: 140

°C ~ 160°C ±5°C, within 2 minutes.

Operation heating: 235

°C (Max) within 10 seconds (Max)

Gradual Cooling (Avoid quenching)

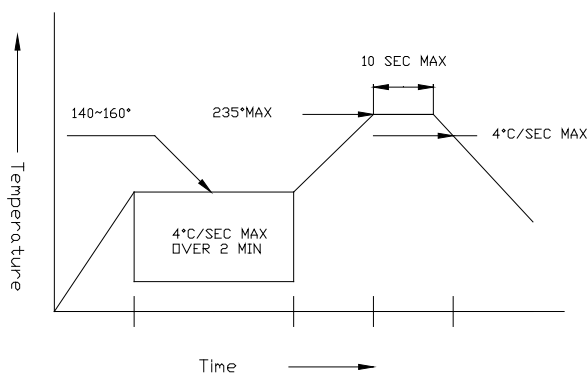

## •Handling:

Care must be taken not to cause to the epoxy resin portion of Yetda LEDs while it is exposed to high temperature.

Care must be taken not rub the epoxy resin portion of Yetda LEDs with hard or sharp article such as the sand blast and the metal hook