



# YETDA INDUSTRY LTD.

## Technical Data Sheet

MODEL NO : Q106LLZ4U

106 Super Flux 4 Pins LED LAMP

Features :

- Compatible with automatic placement equipment
- Compatible with reflow solder process

Applications :

- Indicators

Dice material	Emitted color	Lens Color
AlGaInP	Yellow	Water Clear

Electrical/Optical Characteristics(Ta=25°C)

Parameter	Test Condition	Symbol	Value			Unit
			Min	Typ	Max	
Dominant wavelength	I <sub>F</sub> =70mA	$\lambda_D$		590		nm
Forward voltage	I <sub>F</sub> =70mA	V <sub>F</sub>		2.2	2.4	V
Luminous Flux	I <sub>F</sub> =70mA	$\phi_V$		2.8		lm
Viewing angle at 50% I <sub>v</sub>	I <sub>F</sub> =70mA	2 $\theta$ 1/2		50		Deg
Reverse current	V <sub>R</sub> =5V	I <sub>R</sub>			100	$\mu$ A



# YETDA INDUSTRY LTD.

Absolute Maximum Ratings(Ta=25°C)

Parameter	Symbol	Value	Unit
Power dissipation	Pd	220	mW
Forward current	I <sub>F</sub>	70	mA
Reverse voltage	V <sub>R</sub>	5	V
Operating temperature range	Top	-20 ~+75	°C
Storage temperature range	Tstg	-30 ~+85	°C
Peak pulsing current (1/8 duty f=1kHz)	I <sub>FP</sub>	100	mA

## PACKAGING DIMENSIONS (mm):

Item: 106

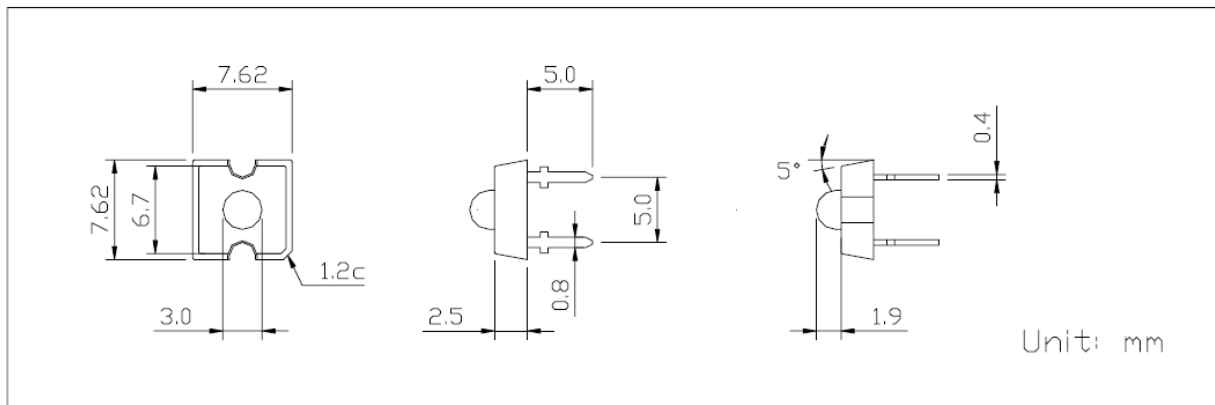



## Typical Electro-Optical Characteristics Curve:

### ■ Typical Electro-Optical Characteristics Curve:

Fig 1. Forward Current vs. Forward Voltage

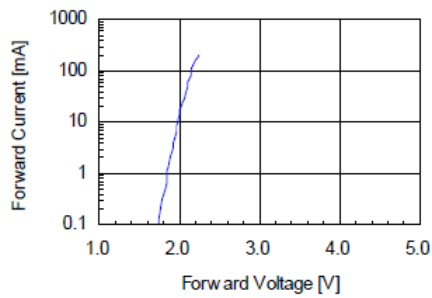

Fig 2. Relative Intensity vs. Forward Current

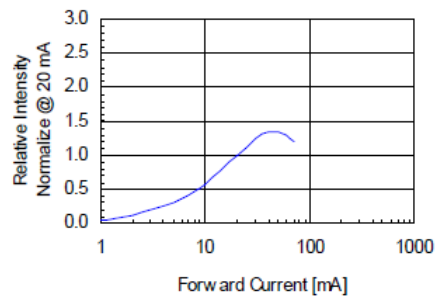

Fig 3. Forward Voltage vs. Temperature

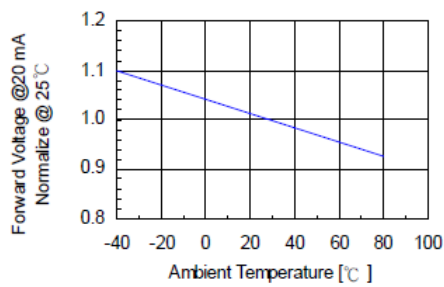

Fig 4. Relative Intensity vs. Temperature

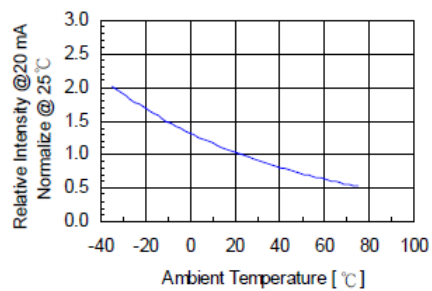
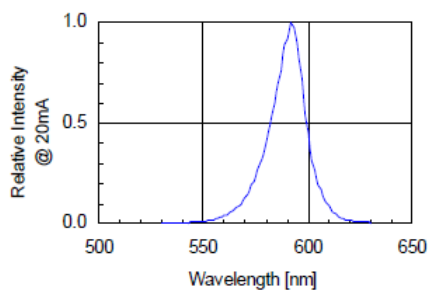

Fig 5. Relative Intensity vs. Wavelength





# YETDA INDUSTRY LTD.

## •Soldering:

### 1. Manual of soldering

The temperature of the iron tip should not be higher than 260°C and Soldering within 3 seconds per solder-land is to be observed

### 2. DIP soldering (Wave Soldering):

Preheating: 120°C ~ 150°C within 5 sec. 260°C (Max)

Gradual Cooling (Avoid quenching)

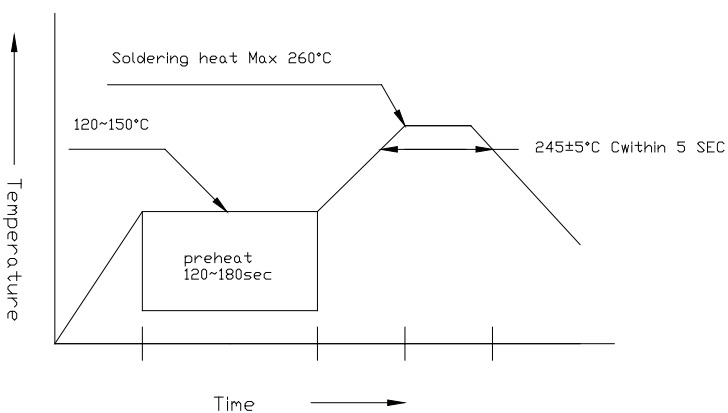

### 3. Reflow Soldering

Preheating: 140°C ~ 160°C ± 5°C, within 2 minutes.

Operation heating: 235°C (Max) within 10 seconds (Max)

Gradual Cooling (Avoid quenching)

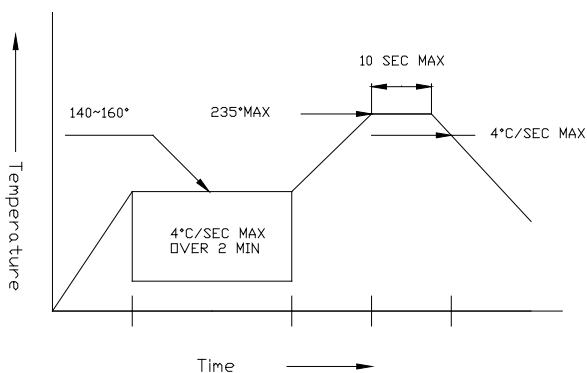

## •Handling:

Care must be taken not to cause to the epoxy resin portion of Yetda LEDS while it is exposed to high temperature.

Care must be taken not rub the epoxy resin portion of Yetda LEDS with hard or sharp article such as the sand blast and the metal hook