



YETDA INDUSTRY LTD.

Technical Data Sheet

MODEL NO : Q106NLI4U

106 Super Flux 4 Pins LED LAMP

Features :

- Compatible with automatic placement equipment
- Compatible with reflow solder process

Applications :

- Indicators

Dice material	Emitted color	Lens Color
AlGaInP	Red	Water Clear

Electrical/Optical Characteristics(Ta=25°C)

Parameter	Test Condition	Symbol	Value			Unit
			Min	Typ	Max	
Dominant wavelength	I _F =70mA	λ_D		625		nm
Forward voltage	I _F =70mA	V _F		2.2	2.4	V
Luminous Flux	I _F =70mA	ϕ_V		5.2		lm
Viewing angle at 50% I _v	I _F =70mA	2 θ 1/2		50		Deg
Reverse current	V _R =5V	I _R			100	μ A



YETDA INDUSTRY LTD.

Absolute Maximum Ratings($T_a=25^{\circ}\text{C}$)

Parameter	Symbol	Value	Unit
Power dissipation	P_d	220	mW
Forward current	I_F	70	mA
Reverse voltage	V_R	5	V
Operating temperature range	T_{op}	-20 ~ +75	$^{\circ}\text{C}$
Storage temperature range	T_{stg}	-30 ~ +85	$^{\circ}\text{C}$
Peak pulsing current (1/8 duty $f=1\text{kHz}$)	I_{FP}	100	mA

PACKAGING DIMENSIONS (mm):

Item: 106

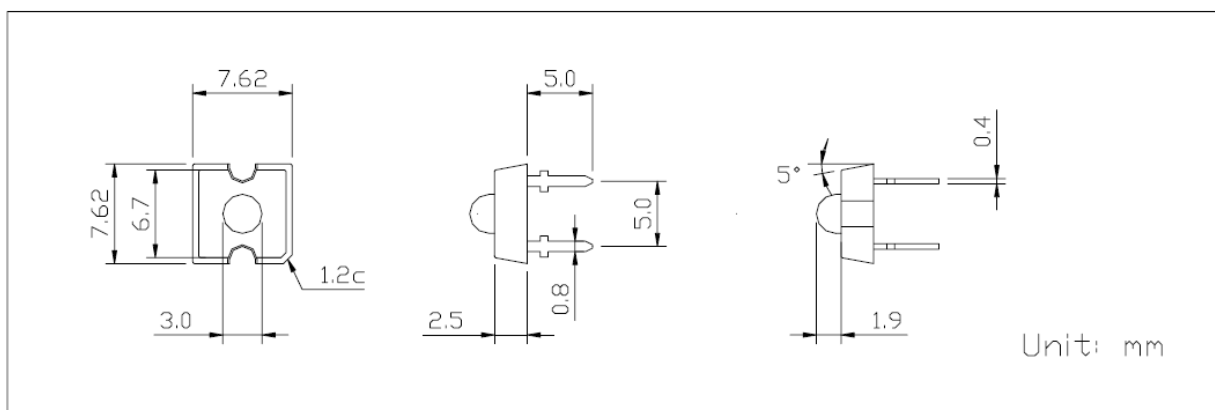



YETDA INDUSTRY LTD.

Typical Electro-Optical Characteristics Curve:

Fig 1. Forward Current vs. Forward Voltage

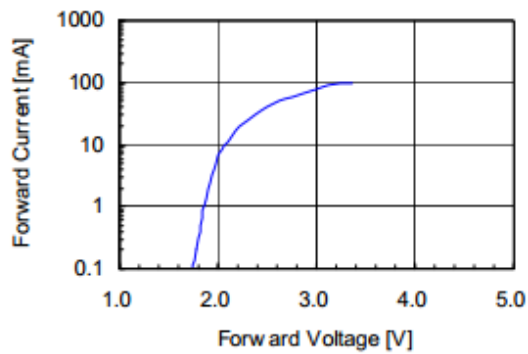

Fig 2. Relative Intensity vs. Forward Current

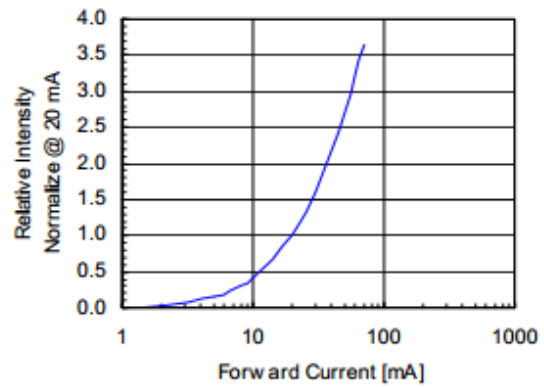

Fig 3. Forward Voltage vs. Temperature

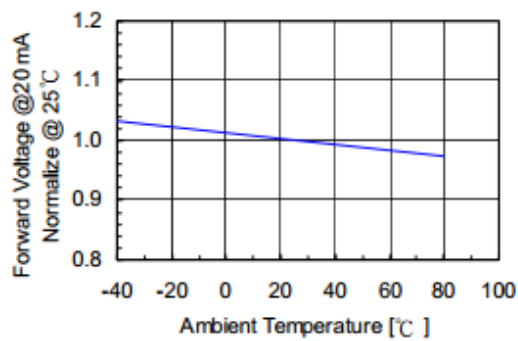

Fig 4. Relative Intensity vs. Temperature

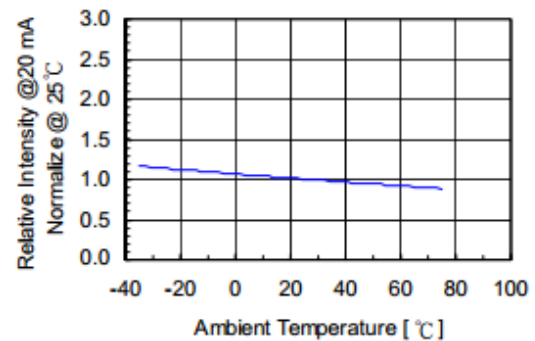

Fig 5. Relative Intensity vs. Wavelength

