



YETDA INDUSTRY LTD.

**FOUR PINS Super Flux – White LED Lamps  
S105TW4U-GB**

4 PINS with InGaN dice ◦

Encapsulated with Water clear package ◦

4 Pins ◦

**Absolute Maximum Ratings : ( Ta=25°C )**

Parameter	Maximum Rating	Unit
Peak Forward Current	100	mA
Continuous Forward Current	20	mA
Operating Temperature Range	-30°C to +80°C	
Storage Temperature Range	-40°C to +80°C	
Lead Soldering Temperature	260°C for 3 seconds 1.6mm(0.063 inch) from body	

**Electro-Optical Characteristics ( Ta = 25°C )**

Parameter Radiant	Test Condition	Symbol	Min.	Typ.	Max.	Unit
Forward Voltage	I <sub>F</sub> = 20mA	V <sub>F</sub>	2.8		3.6	V
Reverse Current	V <sub>R</sub> = 5V	I <sub>R</sub>			10	uA
Luminous Intensity	I <sub>F</sub> = 20mA	I <sub>v</sub>	8000		10000	mcd
Color Temperature	I <sub>F</sub> = 20mA	TC	6000		8000	K
Chromaticity Coordinates	I <sub>F</sub> = 20mA	X		0.30		
		Y		0.32		
Viewing Angle	I <sub>F</sub> = 20mA	2 θ1/2		60		deg

Package

Item: 105

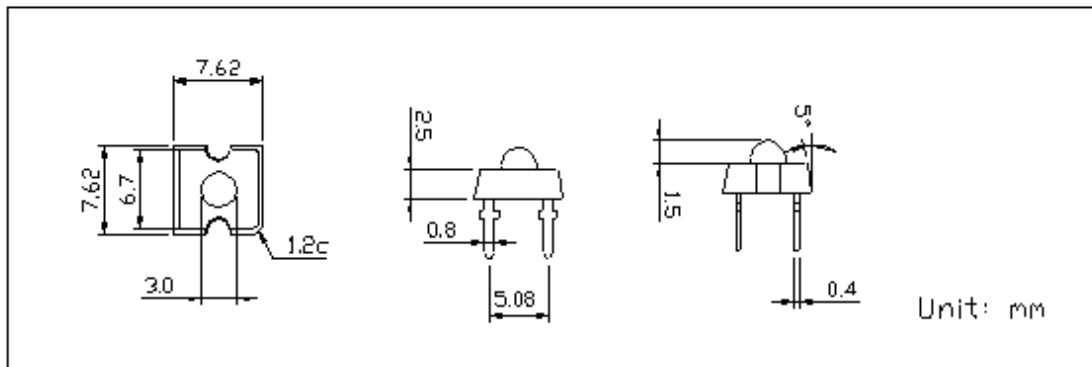



# YETDA INDUSTRY LTD.

## Typical Optical/Electrical Characteristics Curves ( $T_a=25^\circ\text{C}$ Unless Otherwise Noted)

RELATIVE RESPONSE 100%=1.642e-001

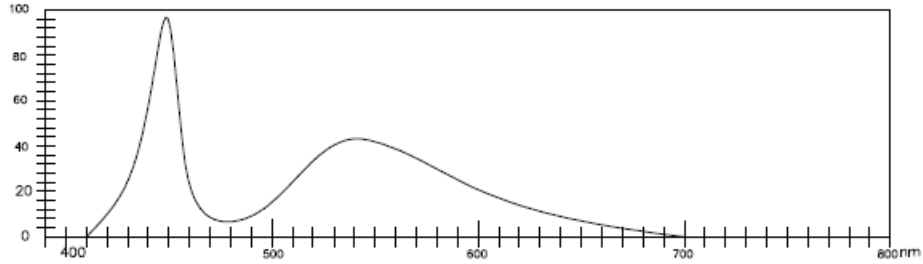

Forward Current vs. Ambient Temperature

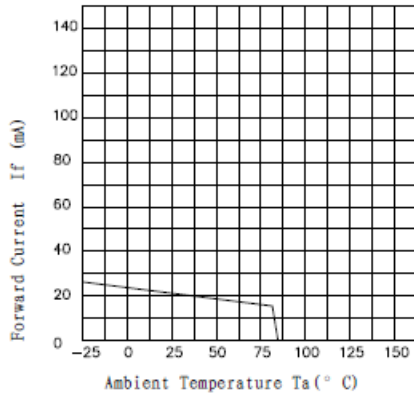

Relative Intensity vs. Ambient Temperature

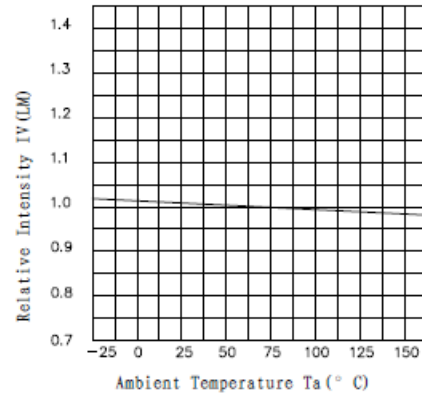

Forward Current vs. Forward Voltage Vf (V)

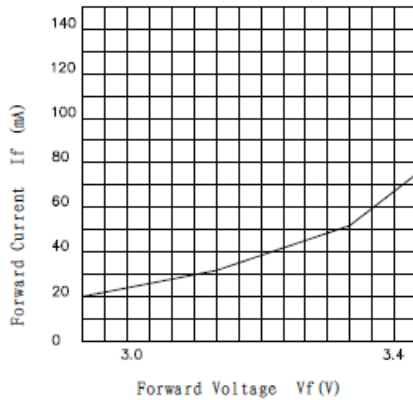

Forward Voltage Vf (V). Ambient Temperature

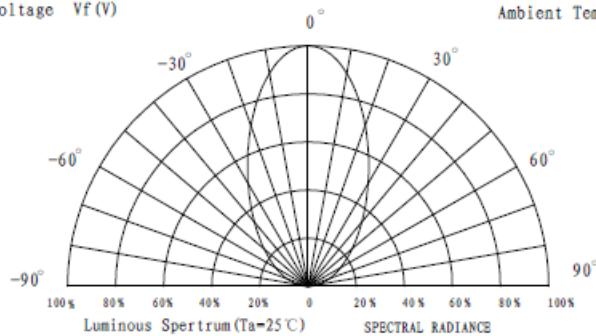
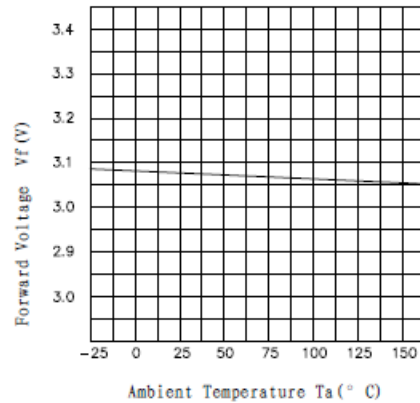



# YETDA INDUSTRY LTD.

## •Soldering:

### 1. Manual of soldering

The temperature of the iron tip should not be higher than 260 °C and

Soldering within 3 seconds per solder-land is to be observed

### 2. DIP soldering (Wave Soldering):

Preheating: 120

°C ~ 150°C within 5 sec. 260°C (Max)

Gradual Cooling (Avoid quenching)

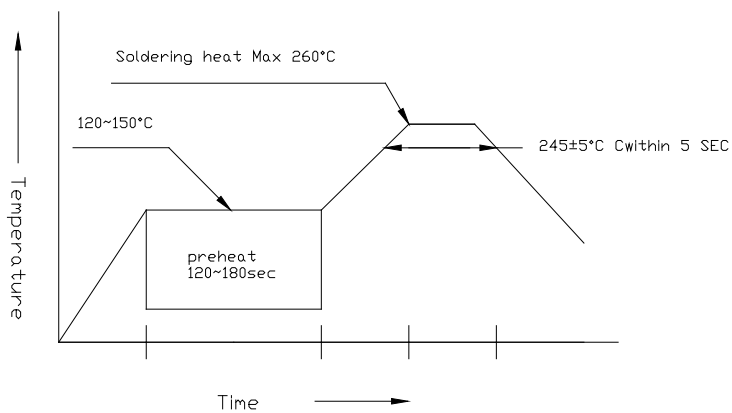

### 3. Reflow Soldering

Preheating: 140

°C ~ 160°C ±5°C, within 2 minutes.

Operation heating: 235

°C (Max) within 10 seconds (Max)

Gradual Cooling (Avoid quenching)

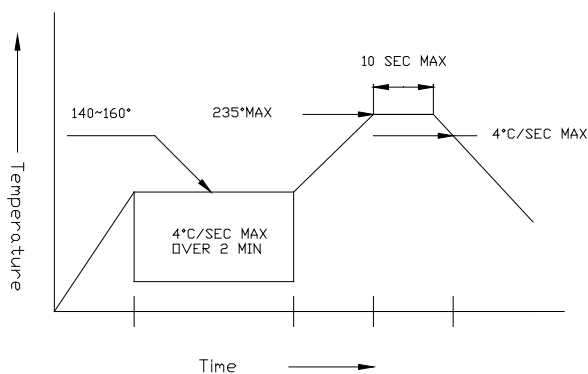

## •Handling:

Care must be taken not to cause to the epoxy resin portion of Yetda LEDs while it is exposed to high temperature.

Care must be taken not rub the epoxy resin portion of Yetda LEDs with hard or sharp article such as the sand blast and the metal hook