



# YETDA INDUSTRY LTD.

## Technical Data Sheet

**MODEL NO : S3535UVC4**

**3535 Package 3.35(L)\*3.35mm(W)\*1.550(T) Chip LEDs**

<p>Features :</p> <ul style="list-style-type: none"> <li>● Quartz glass package</li> <li>● Deep ultraviolet band</li> <li>● long service life</li> </ul> <p>Applications :</p> <ul style="list-style-type: none"> <li>● Sterilization and disinfection</li> <li>● water purification</li> <li>● Air purification</li> <li>● Food preservation</li> </ul>
----------------------------------------------------------------------------------------------------------------------------------------------------------------------------------------------------------------------------------------------------------------------------------------------------------------------------------------------------------

Dice material	Emitted color	Lens Color
InGan	UVC	Water Clear

### Electrical/Optical Characteristics(Ta=25°C)

Parameter	Test Condition	Symbol	Value			Unit
			Min	Typ	Max	
Dominant wavelength	IF=60mA	$\Delta p$	270		285	nm
Forward voltage	IF=60mA	VF	5.5		9.0	V
Radiantflux(mw/mcd)	IF=60mA	$\emptyset e$	5		8	mW
Viewing angle at 50% Iv	IF=60mA	$2 \theta 1/2$		120		Deg
Reverse current	VR=5V	IR			10	$\mu A$

### Absolute Maximum Ratings(Ta=25°C)

Parameter	Symbol	Value	Unit
Power dissipation	Pd	200	mW
Forward current	IF	60	mA
Reverse voltage	VR	$\leq 20$	$^{\circ}C/W$
Operating temperature range	Top	-40 ~+60	$^{\circ}C$
Storage temperature range	Tstg	-40 ~+85	$^{\circ}C$
Peak pulsing current (1/8 duty f=1kHz)	I <sub>fp</sub>	100	mA

- Tolerance of measurement of Luminous Flux or Radiometric Power:  $\pm 10\%$
- Tolerance of measurement of wavelength:  $\pm 2nm$
- Tolerance of measurement of Forward Voltage:  $\pm 0.05V$
- All the data are just for reference, specific parameters refer to the label

13JUN17H



PACKAGING DIMENSIONS



注意：操作时应注意静电敏感

侧视图  
Side View

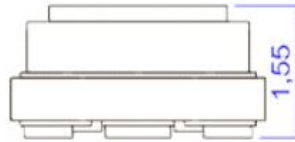

俯视图  
Top View

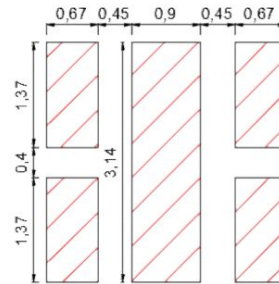
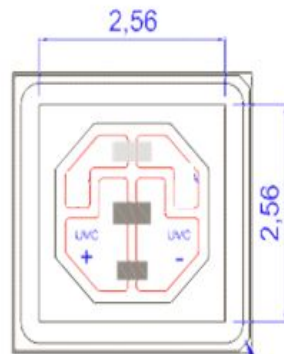

PCB焊盘外形尺寸 (单位: mm)

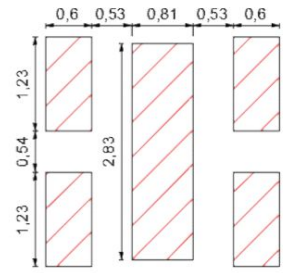

钢网尺寸 (单位: mm)

仰视图  
Bottom View

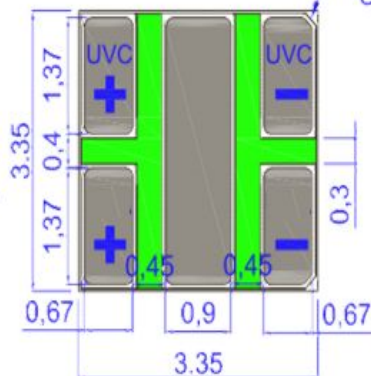

负极标识  
Cathode Mar

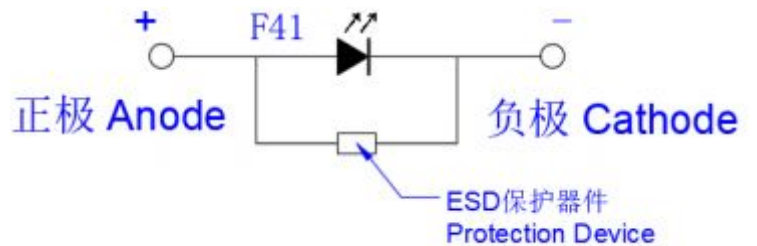

Notes:

1. All dimension units are millimeters.
2. All dimension tolerance is  $\pm 0.2\text{mm}$  unless otherwise noted.



# YETDA INDUSTRY LTD.

Typical Electro-Optical Characteristics Curve:

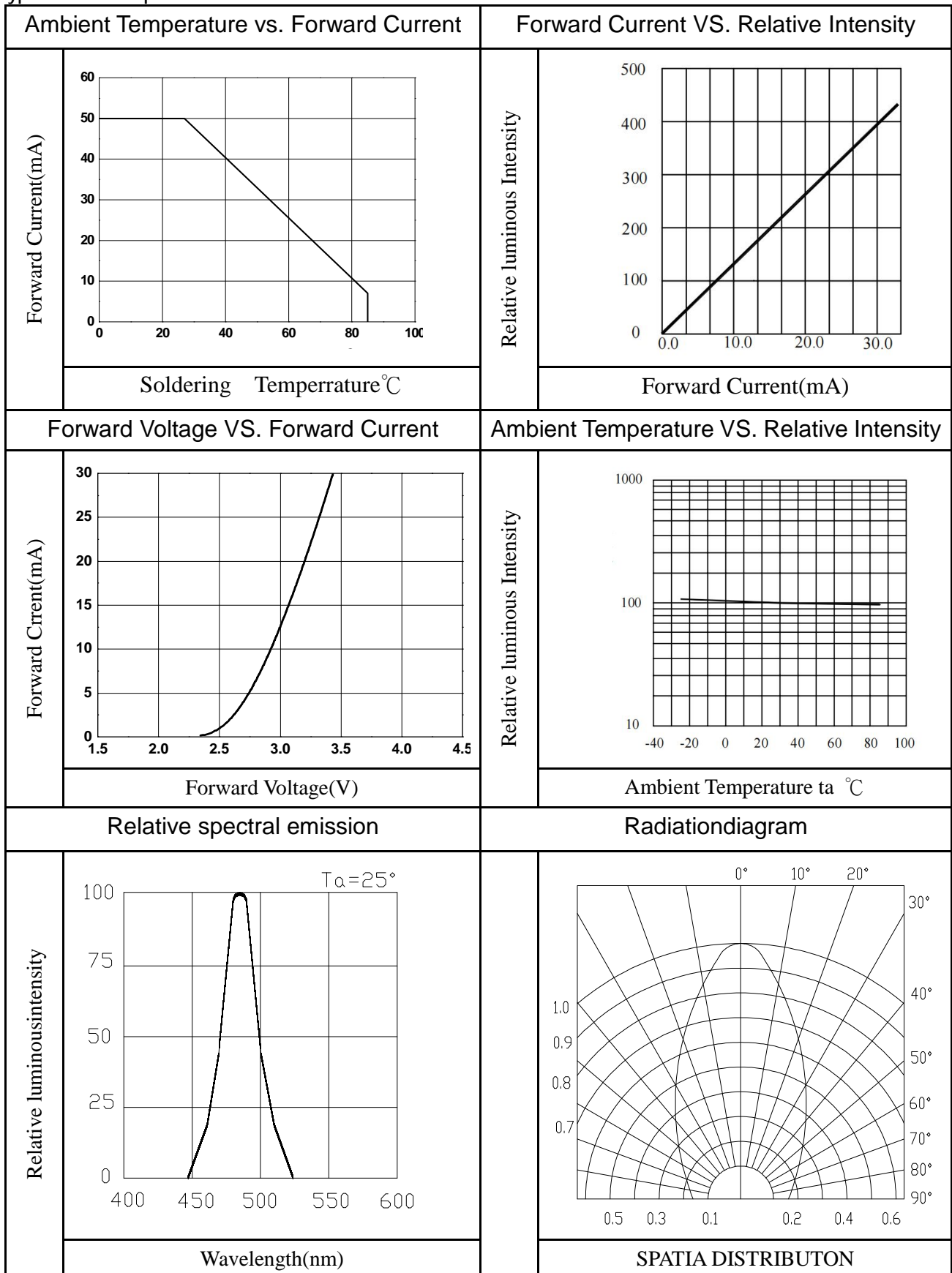



# YETDA INDUSTRY LTD.

## Typical optical characteristics curves 典型光学特性曲线 (UVC)

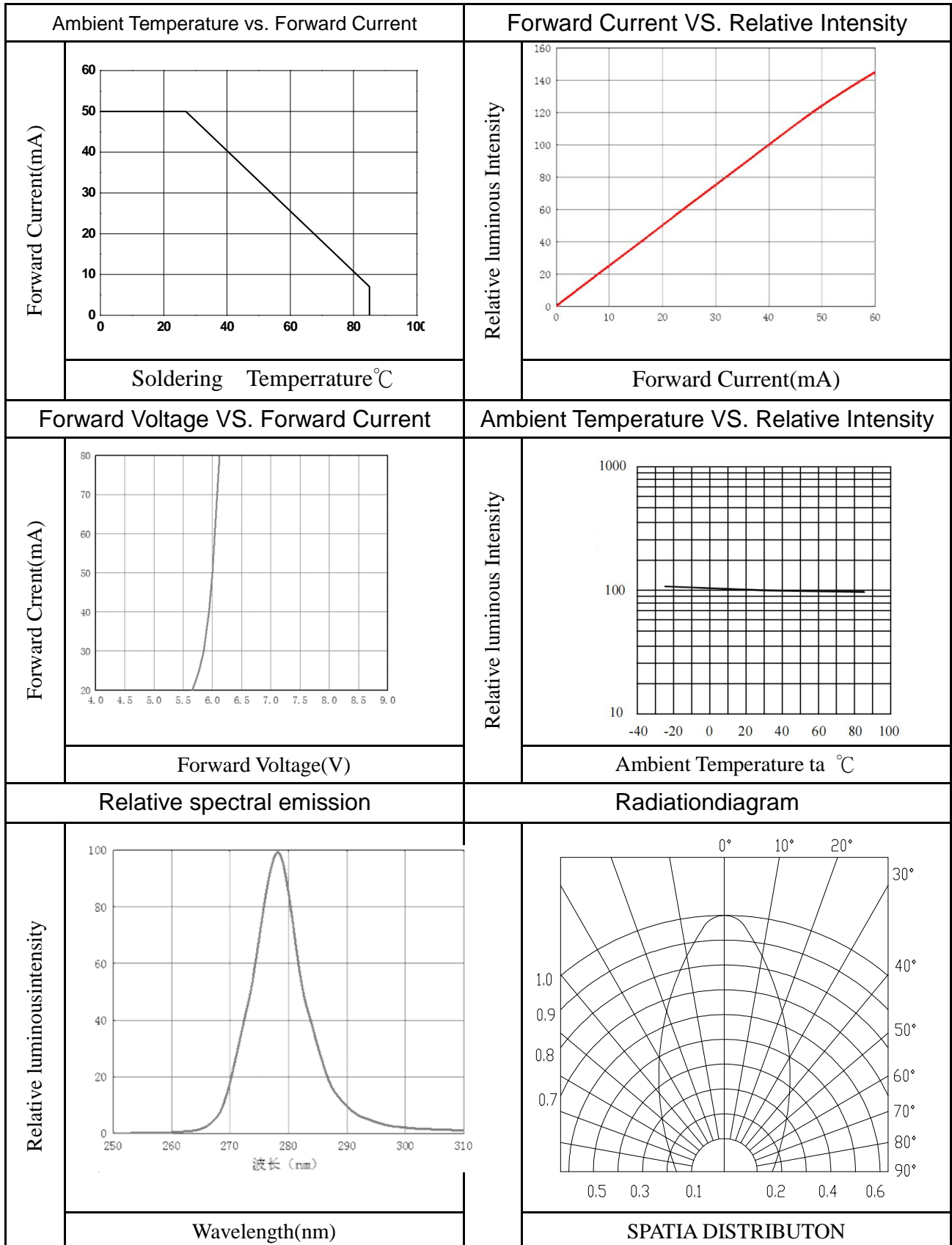



# YETDA INDUSTRY LTD.

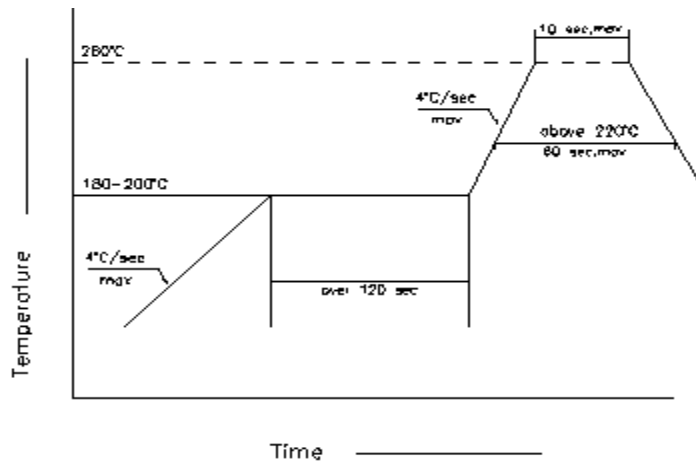

1.Reflow soldering should not be done more than two times. 回流焊不可以做两次以上

2.When soldering , do not put stress on the LEDs during heating

当焊接时，不要在材料受热时用力压胶体表面

## Soldering iron

1.When hand soldering, keep the temperature of iron below less 300°C less than 3 seconds

当手工焊接时，烙铁的温度必须小于 300°C，时间不可超过 3 秒

2.The hand solder should be done only one times

手工焊接只可焊接一次

## Repairing 修补

Repair should not be done after the LEDs have been soldered. When repairing is unavoidable, a doUVAle-head soldering iron should be used (as below figure). It should be confirmed in advance whether the characteristics of LEDs will or will not be damaged by repairing.

LED 回流焊后不应该修复，当修复是不可避免时，必须使用双头烙铁（如下图），但必须事先确认此种方式会或不会损坏 LED 本身的特性。

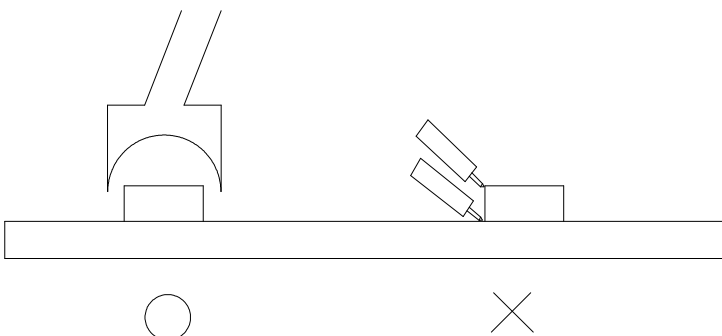



# YETDA INDUSTRY LTD.

## ■Dimensions of Tape (Unit: mm)

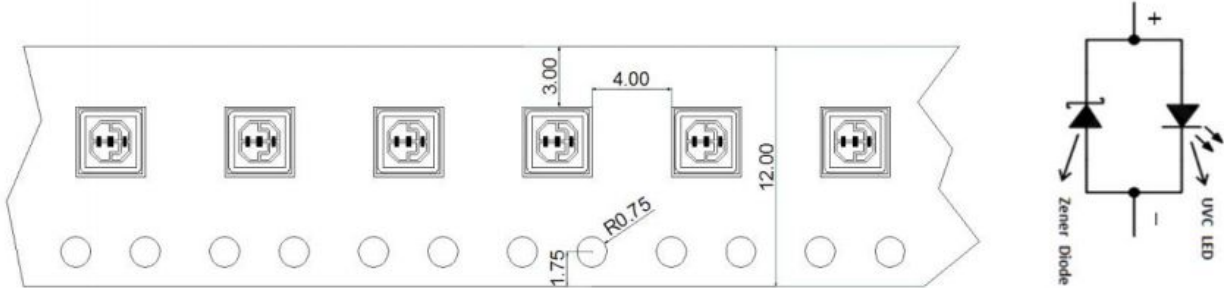

## Reel Dimensions 卷轴尺寸

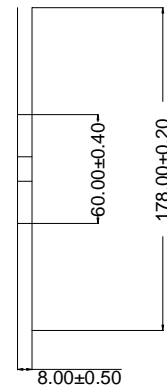
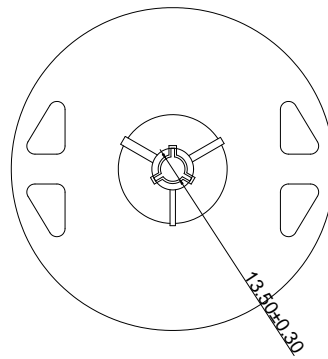

## Moisture Resistant Packaging

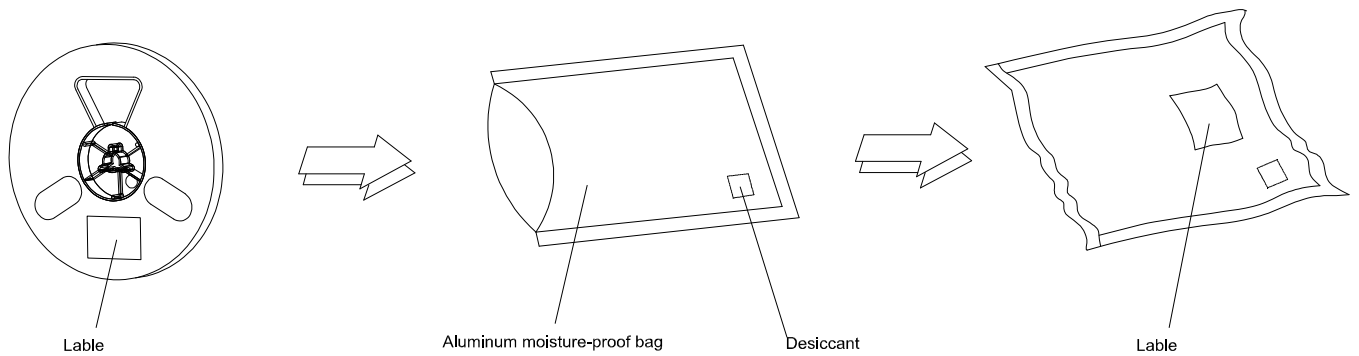

Note: The tolerances unless mentioned is  $\pm 0.1\text{mm}$ , Unit: mm

注：标注公差为 $\pm 0.1\text{mm}$ ，单位：mm